



Project \_\_\_\_\_  
AIA # \_\_\_\_\_ SIS # \_\_\_\_\_  
Item # \_\_\_\_\_ Quantity \_\_\_\_\_ C.S.I. Section 114000



## ABSLBM-20 Long Bread Moulder



### MARKETING SPECIFICATION

Specified Dough Moulder shall be an ABSLBM-20 with solid welded steel frame and Stainless Steel Body Panels, Three Roller Infeed system, infinite thickness settings for degassing rollers, Top and bottom infeed roller scrapers, Stainless Steel infeed with built in safety shut off, Emergency Stop Mounted at Eye Level, Heavy Duty Curling Belt, NSF approved Synthetic Felt Moulding Belts with Infinite Moulding Pressure adjusting system, High Torque Belt Drive system eliminates Gearbox, Heavy Duty Stainless Steel Stand with four locking casters and ETL/UL and ETL/NSF Listings meeting UL 763 and NSF Standard 7



Meets UL 763 and NSF-8 Standards

### Model ABSLBM-20 Long Bread Moulder

#### STANDARD FEATURES

- Strong Welded Steel Frame
- Stainless Steel Body Panels
- Heavy Duty High Torque Belt Drive
- Three Roller Infeed System with Safety Shut off
- Fully wrapped Easy Clean Curling Belt
- Infinite Thickness settings for Degassing and Moulding
- NSF approved Synthetic Felt Curling and Moulding Belts
- Heavy Duty Stainless Steel Stand
- Four Locking Casters for Operating Stability

#### CONTROL AND PERFORMANCE FEATURES

- Three Roller infeed System guides dough through Degassing Rollers
- High torque Belt Drive System Eliminates Gear Box
- Safety infeed guard and Emergency Stop Safety Features
- Automatic Over-Current Protection with Automatic Reset
- Emergency Stop
- Capacity: 800 Pieces per Hour
- 6 Foot Electrical Cord with NEMA Cord Cap

#### OPTIONS AND ACCESSORIES

- Single Phase Electric available

ABSLBM-20 – LONG BREAD MOULDER



MPM Food Equipment Group, LLC  
236 Egidi Drive, Suite A, Wheeling, IL 60090  
Phone: 800-976-6762 Fax: 847-297-6725  
Email: [info@mpmfeg.com](mailto:info@mpmfeg.com)  
WEB: [www.mpmfeg.com](http://www.mpmfeg.com)

Send Orders to: [ABSorders@mpmfeg.com](mailto:ABSorders@mpmfeg.com)



# Long Bread Moulder

# ABSLBM-20

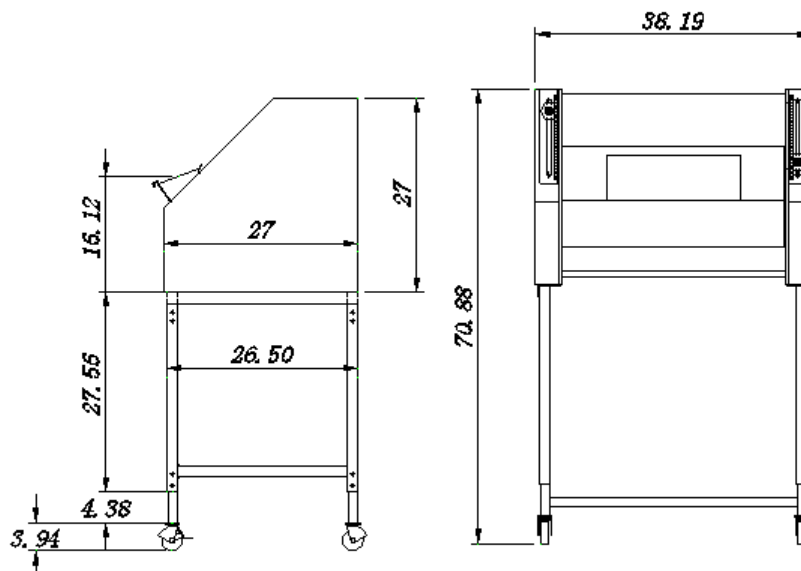

## MODEL ABSLBM-20 UTILITY SPECIFICATIONS

Electrical	220/60/3
Plug	Twist-Lock L15-20P
Breaker	10 Amp Slow-Blow Breaker
Motor HP	1.0
Motor kW	8 Amps

## SHIPPING

Model	Crated Dimensions Height x Width x Depth	Unit Dimensions Height x Width x Depth	Weight	Net Weight	Freight Class	Door Clearance	Fork Lift Delivery Recommended
ABSLBM-10-20	37" x 44" x 36"	70.88" x 38.19" x 26.50"	650	560	85	Verify path from loading dock to install location.	Yes



Send Orders to: [ABSorders@mpmfeg.com](mailto:ABSorders@mpmfeg.com)