



Project _____
AIA # _____ SIS # _____
Item # _____ Quantity _____ C.S.I. Section 114000



ABSBRD-36-4 Bun & Roll Divider/Rounder 36-Part Semi-Automatic



MARKETING

Specified Bun & Roll Divider/Rounder shall be an 4 – 36 Part Semi-Automatic Bun Divider/Rounder with Cast Iron Base finished in NSF epoxy paint and fitted with corner interior anchor system, heavy duty cast Removable Head, Stainless Steel Dividing Knives, operated Variable Rounding control, Oil bath Heavy Duty 3 Phase Motor with silent belt drive, Sanitary NSF Rounding Plates, Front and Rear Safety and ETL/UL and ETL/NSF Listings meeting UL 763 and Standard 8



Meets UL 763 and NSF-8 Standards

Model ABSBRD-36-4 Bun & Roll Divider/Rounder 36-Part

STANDARD FEATURES

- Strong Cast Iron Base with Interior Anchor System
- Finished in NSF Epoxy Paint- Easy Clean & Chip Resistant
- Easily Removable Head and Knife Assembly-Machine Washable
- Variable Rounding for Soft or Heavy Doughs
- Heavy Duty 3-Phase Motor with Silent Belt Drive
- Oil Bath Transmission Insures Long Life
- Sanitary NSF 36 Part Plastic Rounding Plates
- Safety Covers- Front and Rear 208/220/60/3

CONTROL AND PERFORMANCE FEATURES

- Heavy Cast Base for Rounding Stability
- Heavy Duty 220 Volt, 3 Phase, 60 Hz Motor
- Hand operated Lever for Degassing and cutting
- Automatic Over-Current Protection with External Reset
- Variable Rounding allows for handling a variety of Dough Types
- Capacity: 9 lbs. dough; Dough Pieces: 1 oz to 4 oz.
- 6 Foot Electrical Cord with NEMA Cord Cap

OPTIONS AND ACCESSORIES

- Single Phase Electric available

STANDARD PRODUCT WARRANTY

- One Year Parts and Labor (Contiguous USA and Canada Mainland)

ABSBRD-36-4 – Bun & Roll Divider/Rounder 36 Part Semi-Automatic



MPM Food Equipment Group, LLC
236 Egidi Drive, Suite A, Wheeling, IL 60090
Phone: 800-976-6762 Fax: 847-297-6725
Email: info@mpmfeg.com
WEB: www.mpmfeg.com

Send Orders to: ABSorders@mpmfeg.com



Bun & Roll Divider/Rounder ABSBRD-36-4

36-Part Semi-Automatic

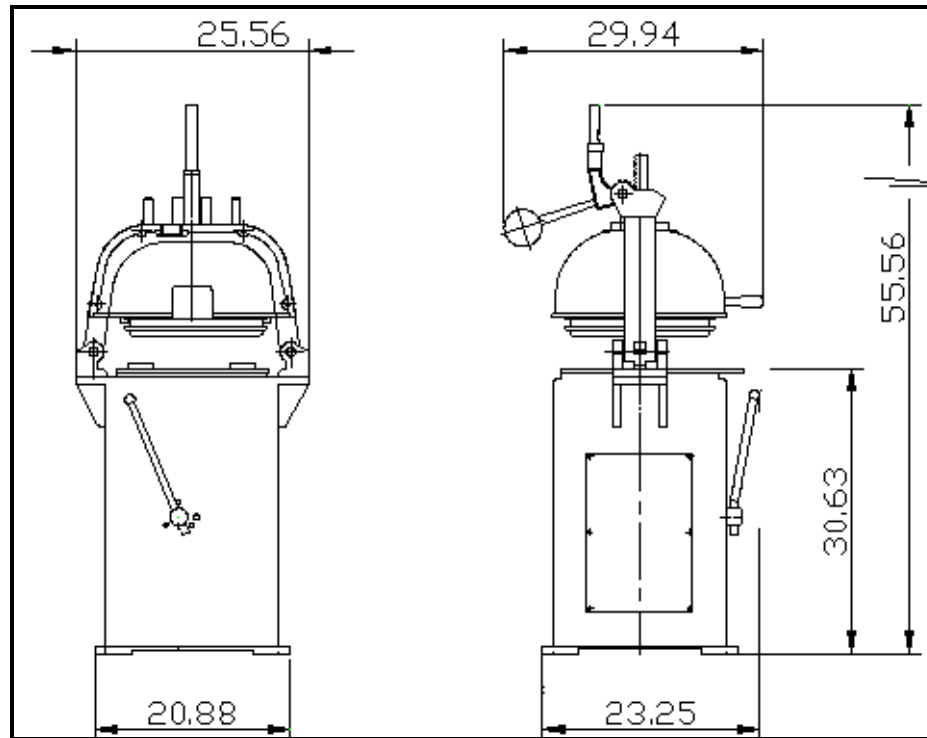

MODEL ABSBRD-36-4 UTILITY SPECIFICATIONS

Electrical	208-220/60/3
Plug	Twist-Lock P&S L1520P
Breaker	10 Amp Slow-Blow Breaker
Motor HP	1.0
Motor kW	4 Amps

ABSBRD-36-4 CAPACITIES

Model	Scaling Range
ABSBRD-36-4	1.5 - 4.0 oz

SHIPPING

Model	Crated Dimensions Height x Width x Depth	Unit Dimensions Height x Width x Depth	Weight	Net Weight	Freight Class	Door Clearance	Fork Lift Delivery Recommended
ABSBRD-36-4	62" x 29" x 33"	52" x 26" x 30"	870	720	85	36" or wider	Yes

Send Orders to: ABSorders@mpmfeg.com

